



SAUGATUCK  
COMMERCIAL  
REAL ESTATE LLC

LICENSED IN CT, NY, MA, RI, NH, FL

## WHITE BIRCH CENTER WESTPORT, CT

361 POST ROAD WEST



POST ROAD  
WHITE BIRCH  
CENTER

3,582 SF ENDCAP  
RETAIL/  
RESTAURANT



- Second generation restaurant space. Other retail uses welcome.
- High-traffic corridor with excellent visibility, signage and parking.
- Located between Whole Foods and Main Street Westport.
- Convenient location to major roadways - I-95, the Merritt Parkway and Route 7.
- Opportunity for vertical development.

Demographics	1 Mile	3 Mile	5 Mile
Population	8,808	72,969	137,739
Average HHI	\$235,629	\$211,646	\$226,081
Total Retail Expenditures	\$246.07 M	\$1.86 B	\$3.43 B

**EXCLUSIVE LEASING AGENT**  
Penny Wickey 203.222.4194  
[pwickey@saugatuckcommercial.com](mailto:pwickey@saugatuckcommercial.com)

Charlie Manuel 203.222.4193  
[cmanuel@saugatuckcommercial.com](mailto:cmanuel@saugatuckcommercial.com)

*The foregoing information was furnished to us by sources which we deem reliable, but no warranty or representation is made as to the accuracy thereof. Subject to correction of errors, omissions, change of price, prior sale or withdrawal from market without notice.*



SAUGATUCK  
COMMERCIAL  
REAL ESTATE LLC

LICENSED IN CT, NY, MA, RI, NH, FL

## WHITE BIRCH CENTER WESTPORT, CT

### 361 POST ROAD WEST

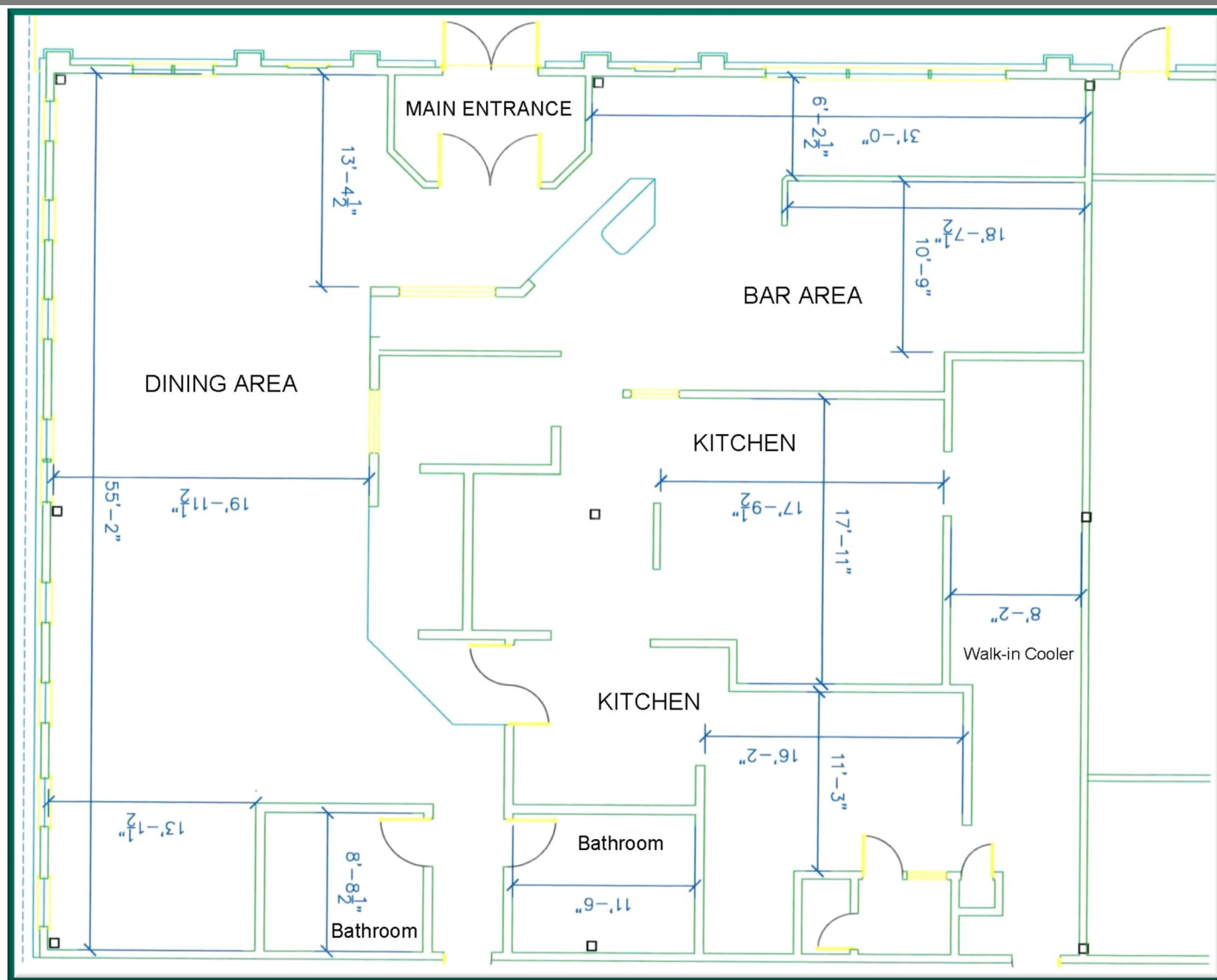

**EXCLUSIVE LEASING AGENT**  
Penny Wickey 203.222.4194  
[pwickey@saugatuckcommercial.com](mailto:pwickey@saugatuckcommercial.com)

Charlie Manuel 203.222.4193  
[cmanuel@saugatuckcommercial.com](mailto:cmanuel@saugatuckcommercial.com)

*The foregoing information was furnished to us by sources which we deem reliable, but no warranty or representation is made as to the accuracy thereof. Subject to correction of errors, omissions, change of price, prior sale or withdrawal from market without notice.*



# WHITE BIRCH CENTER WESTPORT, CT

## 361 POST ROAD WEST

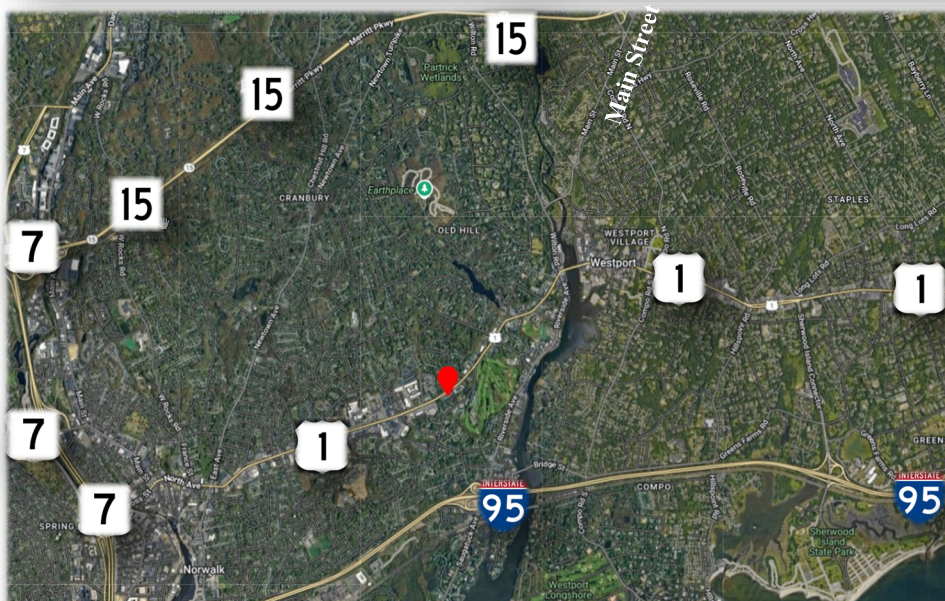
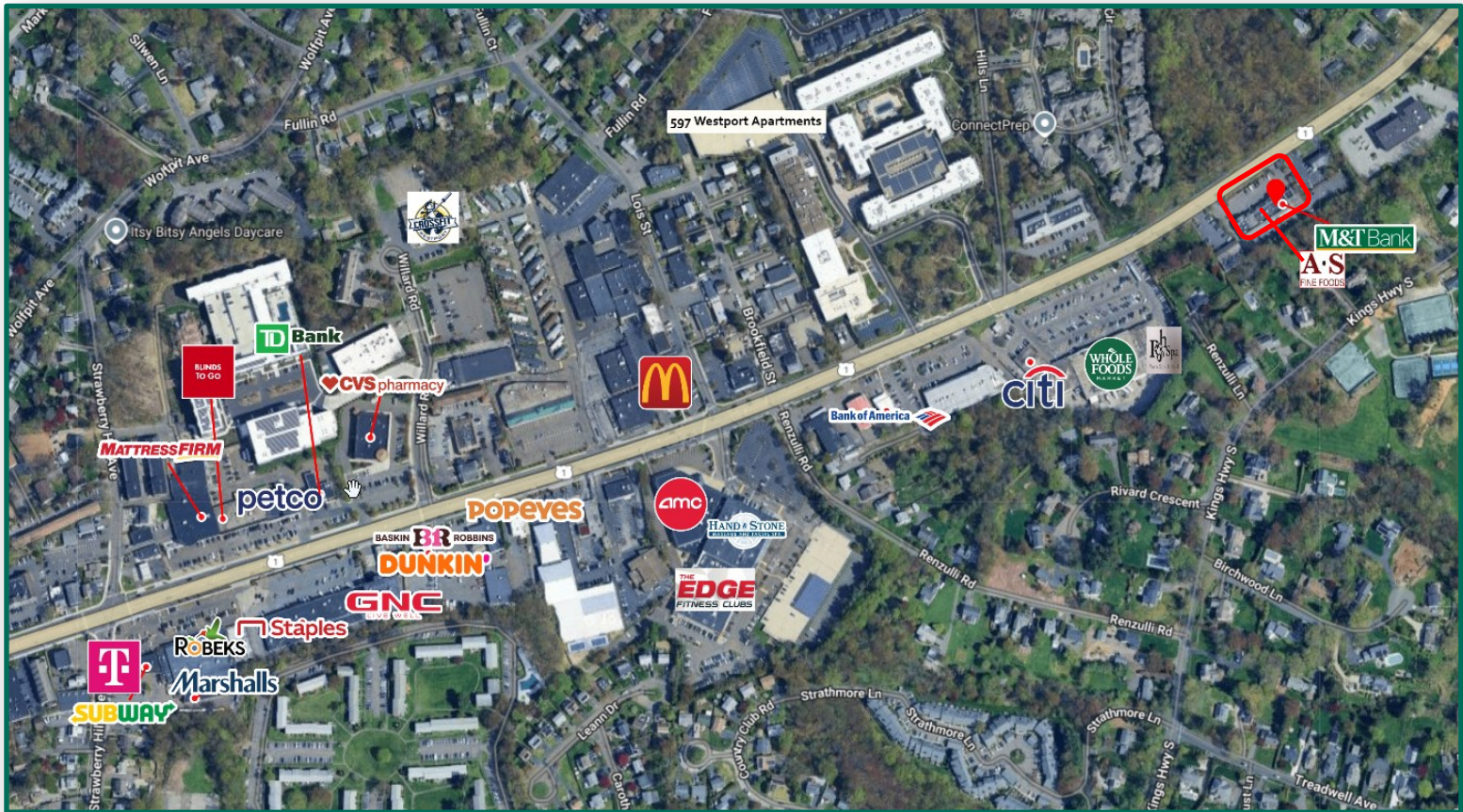

**EXCLUSIVE LEASING AGENT**  
Penny Wickey 203.222.4194  
[pwickey@saugatuckcommercial.com](mailto:pwickey@saugatuckcommercial.com)

Charlie Manuel 203.222.4193  
[cmanuel@saugatuckcommercial.com](mailto:cmanuel@saugatuckcommercial.com)

*The foregoing information was furnished to us by sources which we deem reliable, but no warranty or representation is made as to the accuracy thereof. Subject to correction of errors, omissions, change of price, prior sale or withdrawal from market without notice.*