



**SAUGATUCK  
COMMERCIAL**  
REAL ESTATE LLC  
LICENSED IN CT, NY, MA, RI, NH, FL

**WESTPORT, CT**

**125 MAIN STREET**



**DOWNTOWN  
WESTPORT**

**CENTER OF  
MAIN STREET**

**3,000 SF RETAIL/  
RESTAURANT/MEDICAL**  
(LOWER LEVEL)

**2,358 SF OFFICE/  
RETAIL/MEDICAL**  
(3RD FLOOR)



- Prominent Main Street retail building in one of the most prestigious shopping districts in Fairfield County.
- Join neighboring retailers GAP, Vince, The Shade Store, Athleta, Lululemon and Sundance.
- Dramatic high ceilings on all levels, with over 60' of frontage on Main Street.
- Overlooks the Saugatuck River and Main Street with elevator access directly from Parker Harding Plaza.
- Excellent signage and parking on both Main Street and Parker Harding Plaza.

Demographics	1 Mile	3 Mile	5 Mile
Population	5,953	47,895	127,715
Average HHI	\$337,725	\$249,701	\$196,959

Exclusive Brokers:  
Laure Aubuchon 203.349.8485  
laubuchon@saugatuckcommercial.com

Penny Wickey 203.222.4194  
pwickey@saugatuckcommercial.com

*The foregoing information was furnished to us by sources which we deem reliable, but no warranty or representation is made as to the accuracy thereof. Subject to correction of errors, omissions, change of price, prior sale or withdrawal from market without notice.*



SAUGATUCK  
COMMERCIAL  
REAL ESTATE LLC  
LICENSED IN CT, NY, MA, RI, NH, FL

# WESTPORT, CT 125 MAIN STREET

## PARKER HARDING PLAZA

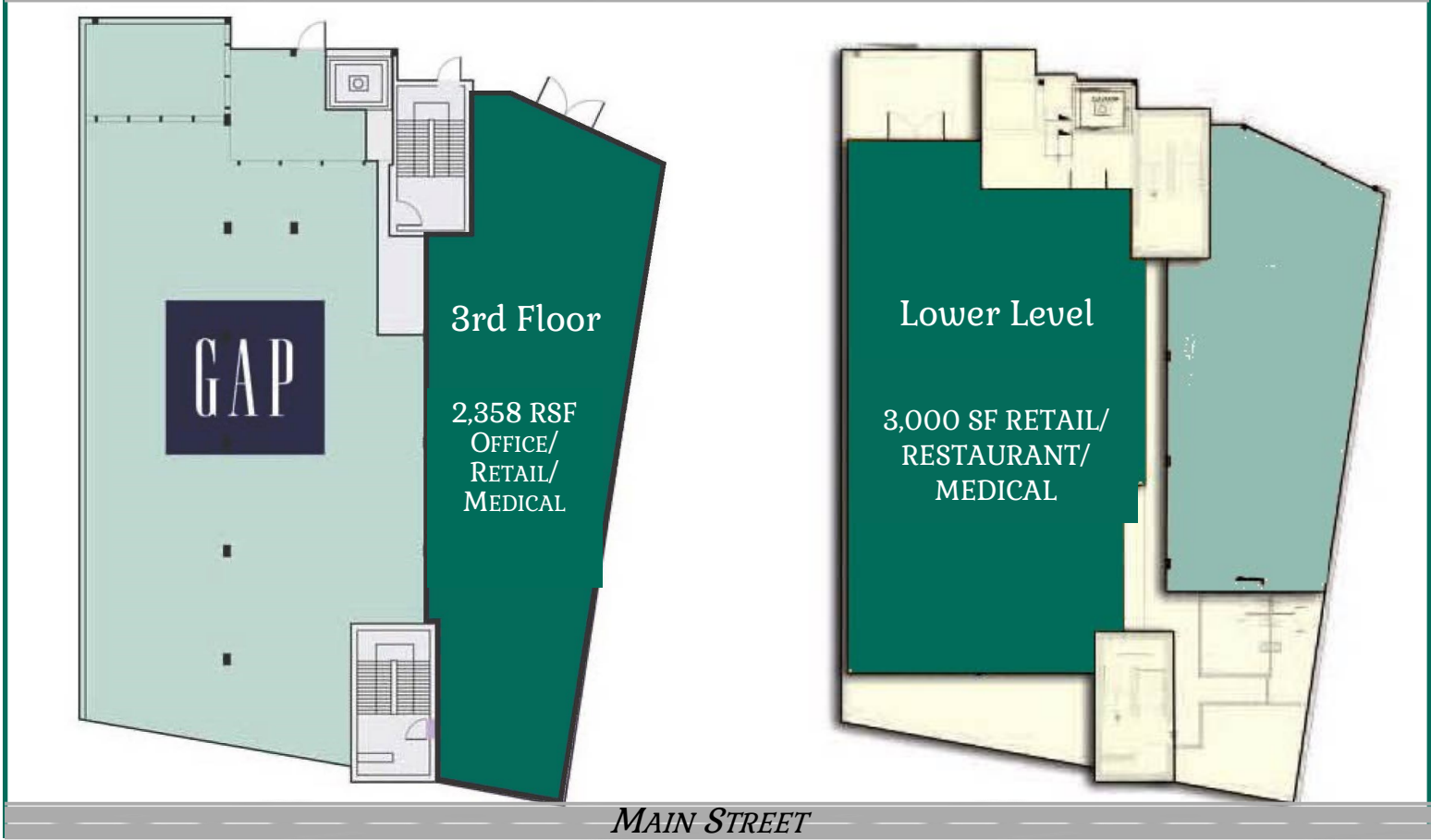

Exclusive Brokers:  
Laure Aubuchon 203.349.8485  
laubuchon@saugatuckcommercial.com

Penny Wickey 203.222.4194  
pwickey@saugatuckcommercial.com

The foregoing information was furnished to us by sources which we deem reliable, but no warranty or representation is made as to the accuracy thereof. Subject to correction of errors, omissions, change of price, prior sale or withdrawal from market without notice.





**SAUGATUCK  
COMMERCIAL**  
REAL ESTATE LLC  
LICENSED IN CT, NY, MA, RI, NH, FL

# WESTPORT, CT 125 MAIN STREET



*Exclusive Brokers:*  
 Laure Aubuchon 203.349.8485  
 laubuchon@saugatuckcommercial.com  
 Penny Wickey 203.222.4194  
 pwickey@saugatuckcommercial.com